

Eaves Court

The Retreat, Princes Risborough



With excellent views from a private balcony across the landscaped gardens and beyond, this most attractive two bedroom apartment is situated on the first floor. An entrance hall with storage cupboards leads to a spacious living/dining room, having glazed doors to a modern kitchen with appliances. The master bedroom has a refurbished ensuite shower.

One Reception / Kitchen / Two Bedrooms / Two Bathrooms / Hall / Balcony

Offers over **£375,000**

rightmove



zoopla

www.anchorresales.org.uk / 0808 296 8453

Eaves Court

"We are very happy with our new home and the welcome we've received convinces us that we've really made the right choice. We are now looking forward to enjoying our new life here."



Approximate Area = 823 sq ft / 76.5 sq m
For identification only - Not to scale

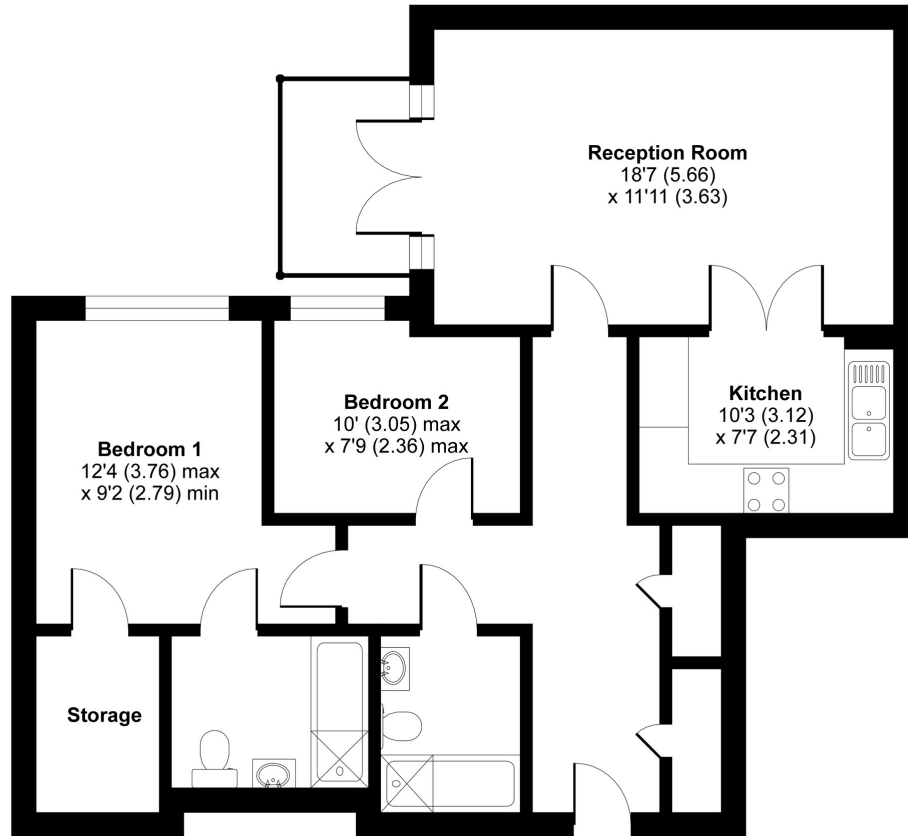

FIRST FLOOR

Key Facts

Lease:	125 years from 1st May 2018 (approx. 120 years remaining)
Service Charge:	£649.74 pcm (£149.54 pw) (reviewed annually, updated from 1st April)
Council Tax band:	D
Sinking Fund:	3% on sale
Age Criteria:	Sole occupiers, or both partners in a couple, must be aged 65 or over, one having a care need

Energy rating:

Score	Energy rating	Current	Potential
92+	A		
81-91	B	85 B	85 B
69-80	C		
55-68	D		
39-54	E		
21-38	F		
1-20	G		

Eaves Court

Located in the heart of Princes Risborough, not far from the Chilterns Area of Outstanding Natural Beauty, Eaves Court is a fabulous development of 69 Independent Living with Care apartments. Enjoying beautiful views, it's situated within walking distance of nearby shops and amenities. The first class facilities include a spacious residents' lounge which opens to a terrace, the Vista café, a Wellness suite featuring a hair salon and fully equipped treatment room, a guest suite for visitors and a cinema room. Plus, you will be provided with two hours of care each week by our dedicated on-site care and support team, Anchor Homecare.

We assume no responsibility for any statement that may be made in these particulars. These particulars do not form part of any offer or contract and must not be relied upon as statements or representations of fact. Any areas, measurements or distances are approximate. The text, photographs and plans are for guidance only and are not necessarily comprehensive. Virtually furnished images may be used for marketing purposes. We have not tested any services, equipment or facilities. Purchasers must satisfy themselves by inspection or otherwise.